

# THIN SHEET NUT-INSERT

MATERIAL : STAINLESS STEEL-A2 ( HALF-HEX TYPE )

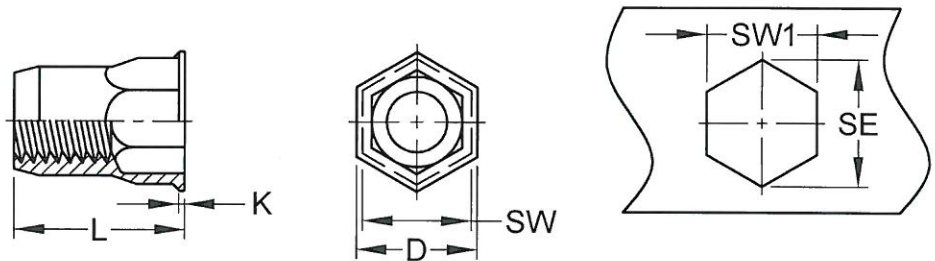

## REDUCED HEAD

THREAD SIZE	ITEM NO.	GRIP RANGE	SW +0 / -0.15	Hex Hole (SW1)	SE Min.	D ±0.3	K +0.3 / -0	L +0.5 / -0
M3 x 0.5	SS-HA SM3	0.5 ~ 2.0	5.00	5.10	5.70	6.00	0.5	9.00
M3 x 0.5	SS-HA SM3-L	1.5 ~ 2.5	5.00	5.10	5.70	6.00	0.5	10.00
M4 x 0.7	SS-HA SM4	0.5 ~ 2.5	6.00	6.10	6.80	7.00	0.5	11.00
M4 x 0.7	SS-HA SM4-L	2.5 ~ 4.0	6.00	6.10	6.80	7.00	0.5	12.50
M5 x 0.8	SS-HA SM5	0.5 ~ 3.0	7.00	7.10	7.90	8.00	0.5	12.00
M5 x 0.8	SS-HA SM5-L	3.0 ~ 4.5	7.00	7.10	7.90	8.00	0.5	13.50
M6 x 1.0	SS-HA SM6	0.5 ~ 3.0	9.00	9.10	10.20	10.00	0.5	14.00
M6 x 1.0	SS-HA SM6-L	3.0 ~ 5.0	9.00	9.10	10.20	10.00	0.5	16.00
M8 x 1.25	SS-HA SM8	0.5 ~ 3.0	11.00	11.10	12.40	12.00	0.5	16.00
M8 x 1.25	SS-HA SM8-L	3.0 ~ 5.0	11.00	11.10	12.40	12.00	0.5	18.50
M10 x 1.50	SS-HA SM10	1.0 ~ 3.5	13.00	13.10	14.80	14.20	0.7	19.00
M10 x 1.50	SS-HA SM10-L	3.5 ~ 6.0	13.00	13.10	14.80	14.20	0.7	21.50
M12 x 1.75	SS-HA SM12	1.0 ~ 4.0	16.00	16.10	17.40	17.20	0.7	22.30

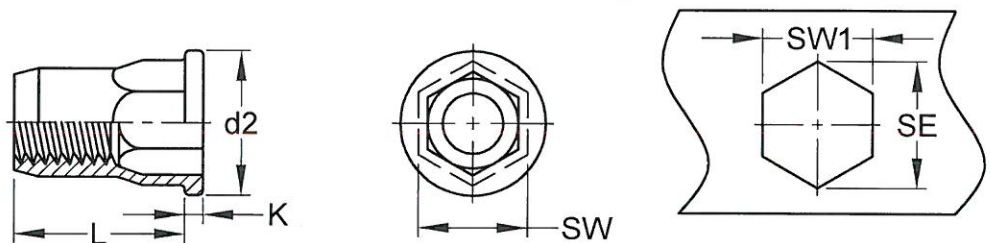

## FLAT HEAD

THREAD SIZE	ITEM NO.	GRIP RANGE	SW +0 / -0.15	Hex Hole (SW1)	SE Min.	d2 +0.5 / -0	K ±0.1	L ±0.3
M4 x 0.7	SS-HA LM4	0.5 ~ 2.5	6.00	6.10	6.80	9.00	1.00	11.00
M4 x 0.7	SS-HA LM4-L	2.5 ~ 4.0	6.00	6.10	6.80	9.00	1.00	12.50
M5 x 0.8	SS-HA LM5	0.5 ~ 3.0	7.00	7.10	7.90	10.00	1.00	12.00
M5 x 0.8	SS-HA LM5-L	3.0 ~ 4.5	7.00	7.10	7.90	10.00	1.00	13.50
M6 x 1.0	SS-HA LM6	0.5 ~ 3.0	9.00	9.10	10.20	12.00	1.50	14.00
M6 x 1.0	SS-HA LM6-L	3.0 ~ 5.0	9.00	9.10	10.20	12.00	1.50	16.00
M8 x 1.25	SS-HA LM8	0.5 ~ 3.0	11.00	11.10	12.40	14.50	1.50	16.00
M8 x 1.25	SS-HA LM8-L	3.0 ~ 5.5	11.00	11.10	12.40	14.50	1.50	18.50
M10 x 1.50	SS-HA LM10	1.0 ~ 3.5	13.00	13.10	14.80	16.50	2.00	19.00

**JET FAST**

JET FAST COMPANY LIMITED.

No. 5 Jwu Gong 2 Lane, Jwu Ho Village, Ren Wu Dist, Kaohsiung City, Taiwan R.O.C.

E-mail : jetfast@ms34.hinet.net TEL : 886-7-3740160

Http://www.jetfast.com.tw

FAX : 886-7-3746310

3D056-B06-08

捷禾管制文件

圖片僅供參考  
Drawing just for reference